

Screw eye Metric

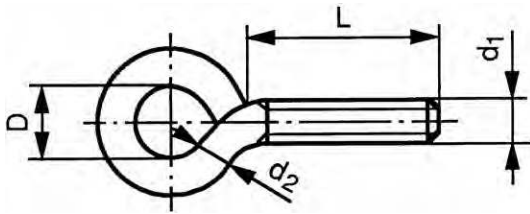

Technical Data

d ₁	d ₂	P	d ₁	d ₂	P
M3	2.6	0.5	M6	5.25	1
M4	3.45	0.7	M8	7.0	1.25
M5	4.4	0.8	M10	8.85	1.5

Materials

Thread	Material	Surface treatment
M	St	Zipl
M	St.St. A2	

Screw eye

Thread	Metric thread	
Material	Steel	
Surface treatment	Zinc plated	

d ₁ x L x D		d ₁ x L x D		d ₁ x L x D	
M3X10X6	100	M5X50X8	100	M8X40X10	100
M3X20X5	100	M5X60X8	100	M8X50X10	100
M4X15X6	100	M6X20X10	100	M8X60X10	100
M4X20X6	100	M6X25X10	100	M8X80X10	50
M4X25X6	100	M6X30X10	100	M8X100X10	50
M4X30X6	100	M6X40X10	100	M10X40X15	50
M4X40X6	100	M6X50X10	100	M10X50X15	50
M5X15X8	100	M6X60X10	100	M10X60X15	50
M5X20X8	100	M6X80X10	100	M10X80X15	50
M5X25X8	100	M6X100X10	100	M10X90X18	50
M5X30X8	100	M8X20X10	100	M10X100X15	50
M5X40X8	100	M8X30X10	100	M10X120X15	50

Screw eye

Thread	Metric thread	
Material	Stainless steel A2	

d ₁ x L x D		d ₁ x L x D		d ₁ x L x D	
M5X15X8	100	M6X30X10	100	M8X60X10	100
M5X30X8	100	M6X40X10	100	M8X80X10	50
M5X50X8	100	M6X60X10	100	M10X70X15	50
M6X20X10	100				