

Lifting eye nut with CE marking

DIN 582

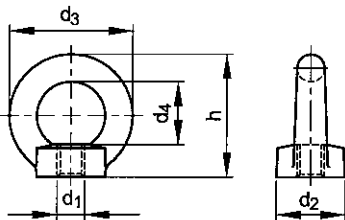

Technical Data

d_1	d_2	d_3	d_4	h	P
M6 (#DIN)	20	36	20	36	1
M8	20	36	20	36	1.25
M10	25	45	25	45	1.5
M12	30	54	30	53	1.75
M14 (#DIN)	30	54	30	53	2
M16	35	63	35	62	2
M18 (#DIN)	35	63	35	62	2.5
M20	40	72	40	71	2.5
M22 (#DIN)	40	72	40	71	2.5
M24	50	90	50	90	3
M27 (#DIN)	65	108	60	109	3
M30	65	108	60	109	3.5
M33 (#DIN)	65	108	60	109	3.5
M36	75	126	70	128	4
M39 (#DIN)	75	126	70	128	4
M42	85	144	80	147	4.5
M48	100	166	90	168	5
M56	110	184	100	187	5.5
M64	120	206	110	208	6
M72x6	150	260	140	260	6

- If lifting eye nuts form part of lifting equipment, CE marking is necessary.
- Lifting eye nuts do not require CE marking if not used for lifting (as towing eyes for example).

Maximum load L (N)

		M6	M8	M10	M12	M14	M16	M18	M20	M22	M24	M27
1 x nut		900	1400	2300	3400	5000	7000	9300	12000	15000	18000	25000
2 x nut		600	1000	1700	2400	3500	5000	6500	8600	10500	12900	18300

		M30	M33	M36	M39	M42	M45	M48	M52	M56	M64	M72x6
1 x nut		32000	42000	46000	60000	63000	78000	86000	99000	115000	160000	200000
2 x nut		23000	30500	33000	44000	45000	55000	61000	71000	82000	110000	140000

Materials

Thread	Material	Class	Surface treatment
M	St C15E		
M	St C15E		Zipl
M	St.St. A2	50	forged
M	St.St. A2		cast
M	St.St. A4	50	forged
M	St.St. A4		cast